

3D: DETALHE DA PONTA
(milímetros)

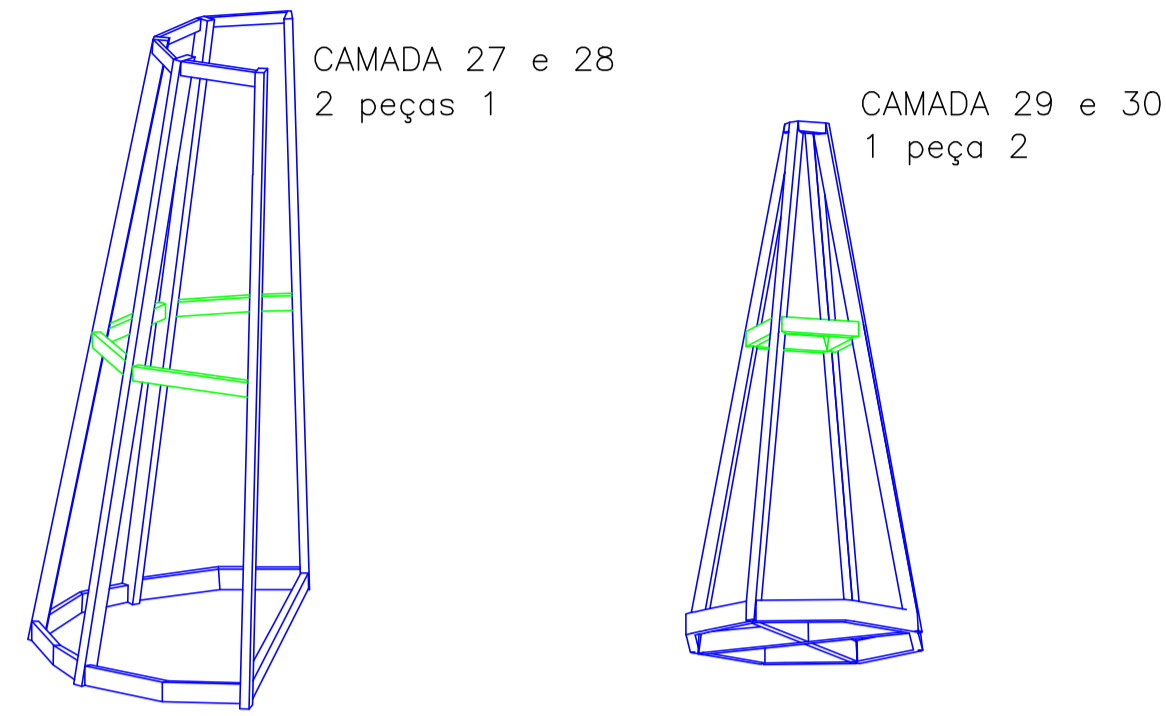

VISTA SUPERIOR PEÇAS 1
(milímetros)

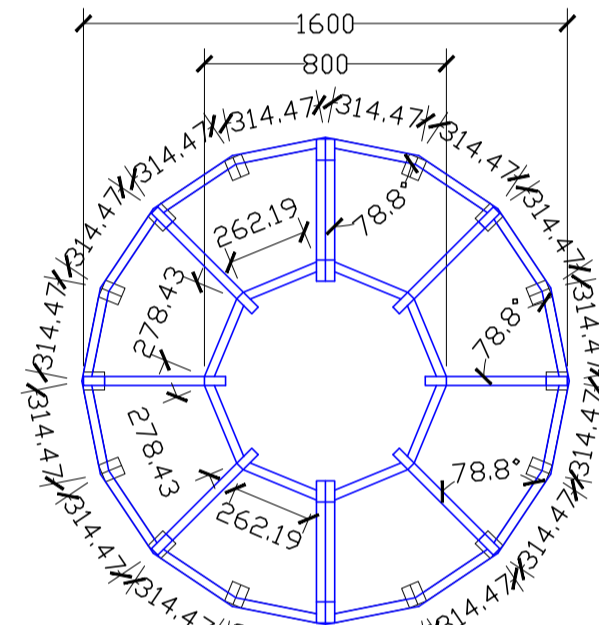

VISTA SUPERIOR PEÇA 2
(milímetros)

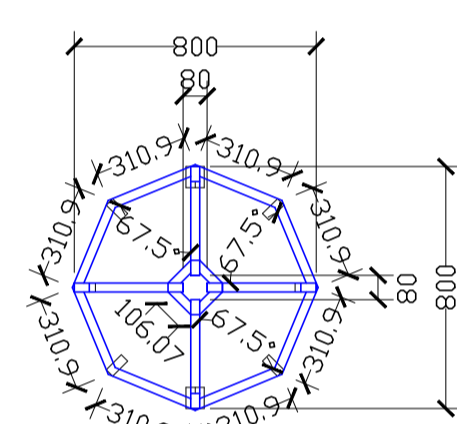

CS 30x2.0x30x2.0
CS 50x2.0x30x2.0
CS 70x2.0x30x2.0

2D: DETALHE DAS AMERICANAS
(milímetros)

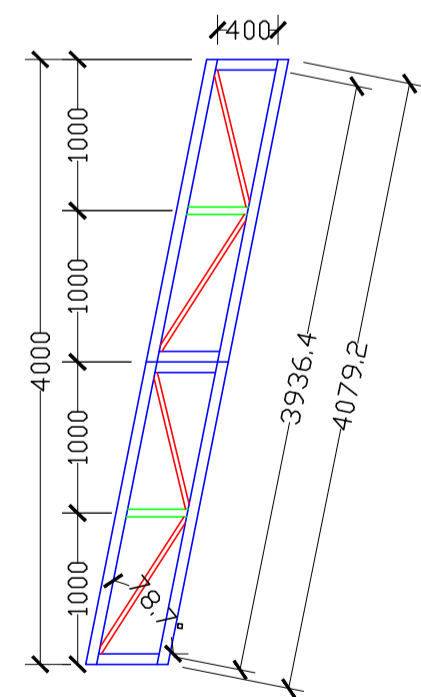

CAMADAS 1, 2, 3 e 4
CAMADAS 5, 6, 7 e 8
CAMADAS 9, 10, 11 e 12

3x 16 = 48 peças

CS 30x2.0x30x2.0
CS 50x2.0x30x2.0
CS 70x2.0x30x2.0

2D: PEÇAS LATERAIS (POSITIVAS)
(milímetros)

CAMADA 25 e 26
8 peças- POS. 8

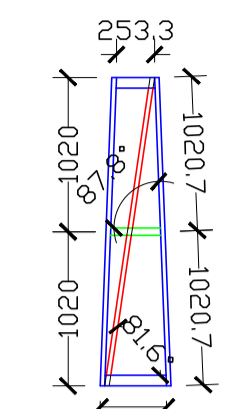

CAMADA 23 e 24
8 peças- POS. 7

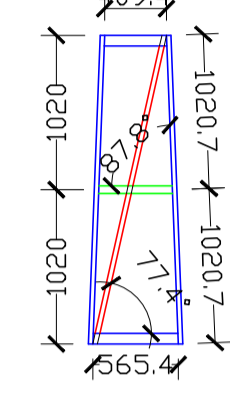

CAMADA 21 e 22
8 peças- POS. 6

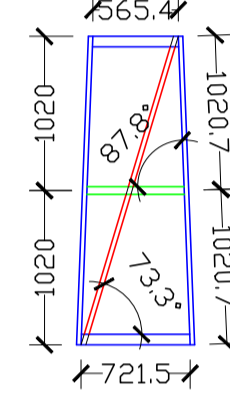

CAMADA 19 e 20
8 peças- POS. 5

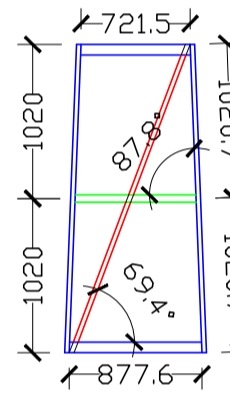

CAMADA 17 e 18
8 peças- POS. 4

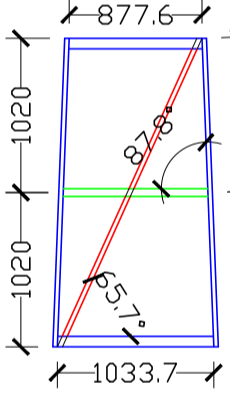

CAMADA 15 e 16
8 peças- POS. 3

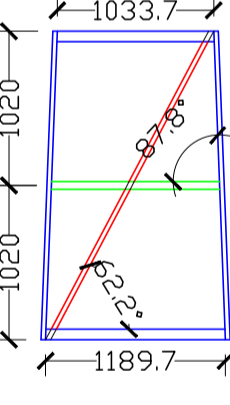

CAMADA 13 e 14
8 peças- POS. 2

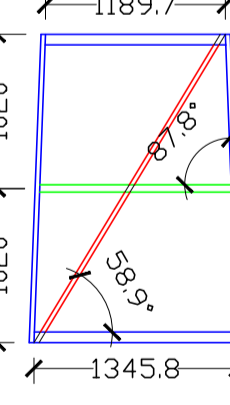

CAMADA 11 e 12
8 peças- POS. 1

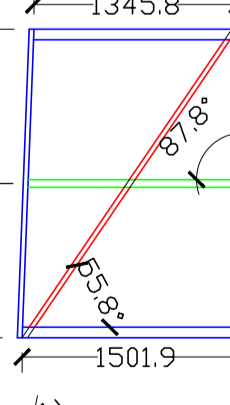

2D: PEÇAS LATERAIS (NEGATIVAS)
(milímetros)

CAMADA 25 e 26
8 peças- NEG. 8

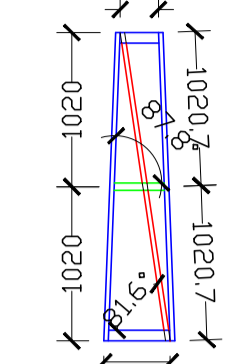

CAMADA 23 e 24
8 peças- NEG. 7

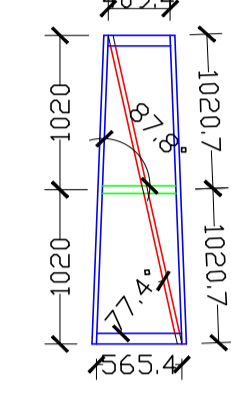

CAMADA 21 e 22
8 peças- NEG. 6

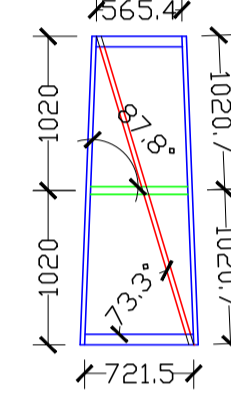

CAMADA 19 e 20
8 peças- NEG. 5

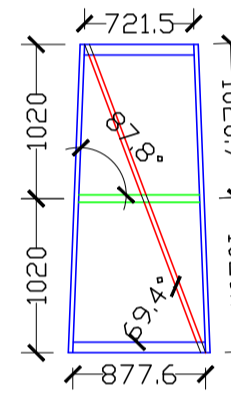

CAMADA 17 e 18
8 peças- NEG. 4

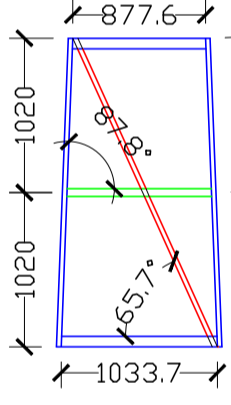

CAMADA 15 e 16
8 peças- NEG. 3

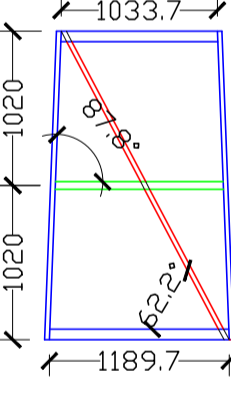

CAMADA 13 e 14
8 peças- NEG. 2

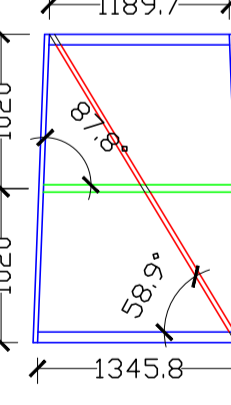

CAMADA 11 e 12
8 peças- NEG. 1

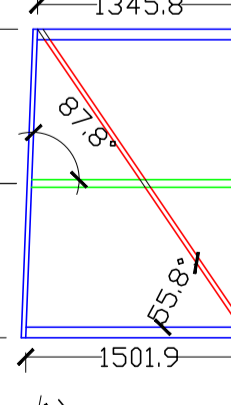

CAMADA 9 e 10
16 peças

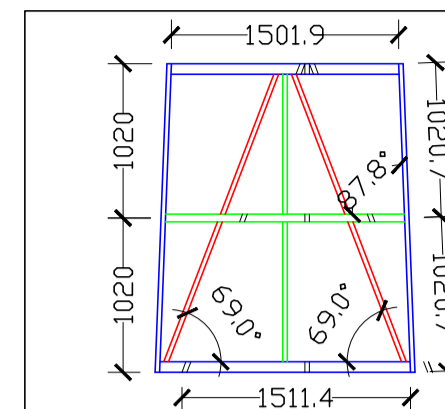

CAMADA 7 e 8
16 peças

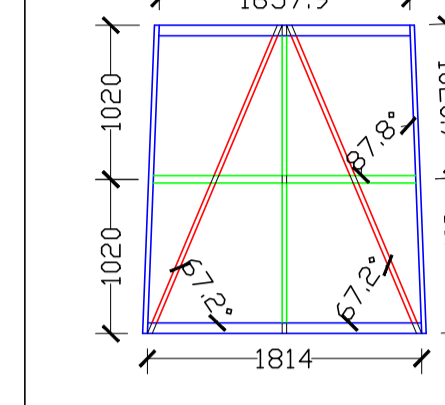

CAMADA 5 e 6
16 peças

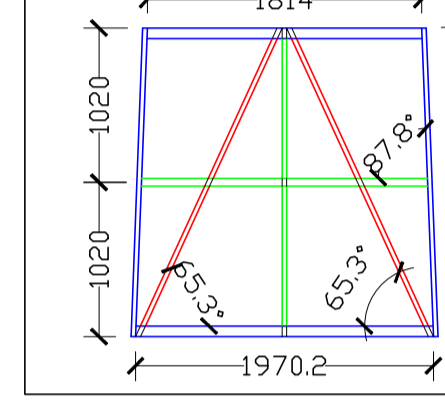

CAMADA 3 e 4
16 peças

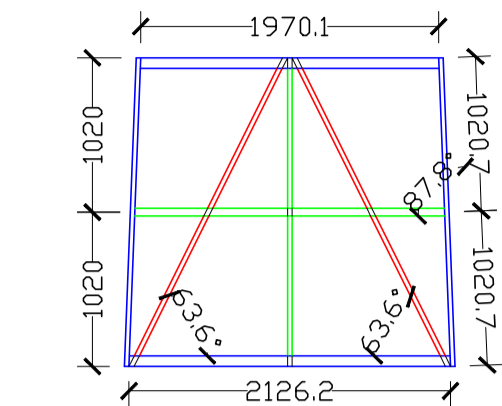

CAMADA 1 e 2
16 peças

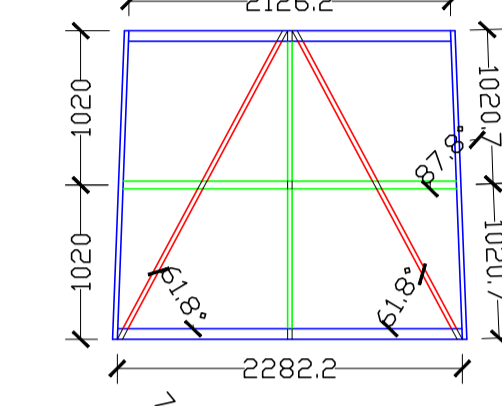

CS 30x2.0x30x2.0
CS 50x2.0x30x2.0
CS 70x2.0x30x2.0

ÁRVORE DE NATAL
30 METROS DE ALTURA
Escala Peças : 1:50
Escala Ponta: 1:25

Resumo Aço	NUMERAÇÃO	Comp. total (m)	Peso (kg)
ÁRVORE DE NATAL 30 METROS			
CS 30x2.0x30x2.0	N1	865	1449
CS 50x2.0x30x2.0	N2	483	1111
CS 70x2.0x30x2.0	N3	2204	6461
Total			9021

NOTAS:

- 1) Dimensões em milímetros.
- 2) Observar referências do local para implantação das medidas.
- 3) Utilizar em geral aços tipo A36 para os perfis dobrados.
- 4) Utilizar filete contínuo de solda de 3mm em todas as superfícies de contato nas ligações dos elementos das peças.
- 5) Utilizar eletrodos E70XX ou superiores.
- 6) Os perfis em contato com o solo devem ser tratados contra corrosão.

REVISÃO	MODIFICAÇÃO	DATA
R7	REFORÇOS	28/05/2019
R8	LIGAÇÕES OCTÓGONO E REFORÇOS	19/08/2019

PROJETO : ÁRVORE 30 METROS	EXPEDIENTE ESTRUTURA
LOCALIZAÇÃO :	ESCALAS 1:50/ 1:25
CLIENTE : VASCONCELOS E SANTOS	DATA: NOV/2022
PRANCHA: 03	DESENHO: DETALHAMENTO DAS PEÇAS
TETO ENGENHARIA, proj. e serv. de const. Ltda. tel: (24) 22311001 teto2engenharia@gmail.com	